

| ITEM NO. | PART NUMBER | DESCRIPTION | WPIP200S Spare Parts/QTY. |
|----------|--------------|----------------------------|---------------------------|
| 21 | WPIP200-P021 | LH Shelf Runner | 8 |
| 31 | WPIP200-P044 | Light; Oven Square | 6 |
| 32 | CMGE-0626 | 740 x 465 Shelf | 8 |
| 33 | WPIP200-A002 | Sliding Glass Door | 2 |
| 36 | CMEL-0731 | Oven Fan (R2K150-AC-03-25) | 1 |
| 37 | SPPO-P16065 | 1/6 65mm Deep Steam Pan | 2 |
| 38 | CMGE-0276 | 32x32 Foot w/Washer | 4 |
| 39 | CMEL-0333 | Thermostat 120deg | 1 |
| 40 | CMEL-0235 | Dial Thermometer 30-120deg | 1 |
| 41 | CMEL-0347 | Thermostat Bezel | 1 |
| 42 | CMEL-0535 | Thermostat Knob 30-120deg | 1 |
| 43 | CMEL-0540 | Indicator Light | 1 |
| 44 | CMGE-0394 | Woodson Decal | 1 |
| 45 | CMEL-0668 | Sonar Switch | 2 |
| 46 | CMEL-0897 | Oven Element | 1 |

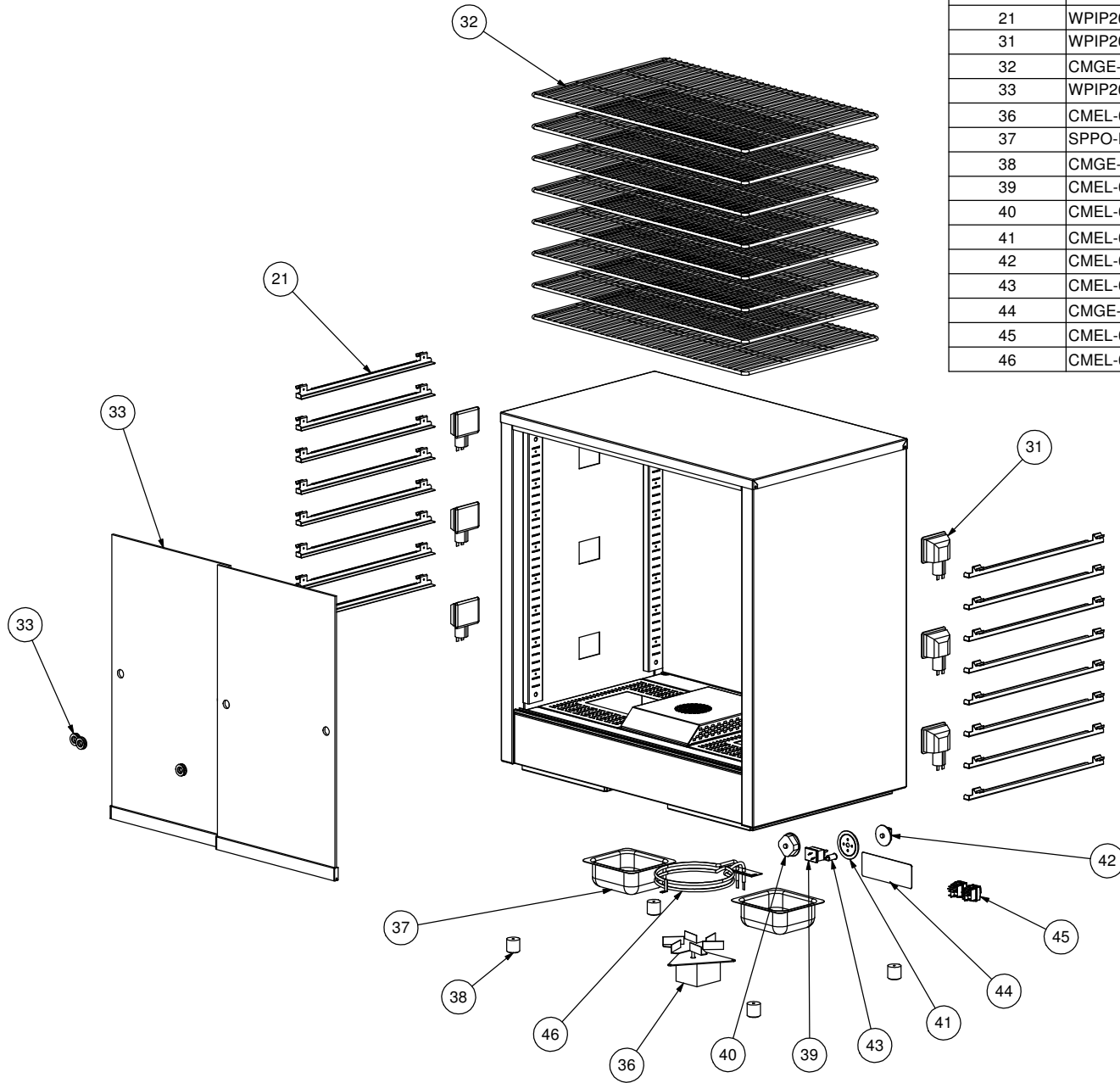

WOODSON - WPIP200S

| | | | | |
|--------|----------------|-------|--------|------|
| Press: | Programmed by: | Date: | Punch: | Die: |
|--------|----------------|-------|--------|------|

**STODDART
MANUFACTURING**
 TOM STODDART Pty Ltd ACN 009 690 251
 215 Jackson Rd Sunnybank Hills Qld 4109
 PO Box 420 Sunnybank Qld 4109
 Phone (617) 3345 5011 Fax (617) 3344 1000
 Email sunnybank@stoddart.com.au
Quality in stainless steel

| | | | | | |
|--------------------------|-----------|------------|--|------------------------------|--|
| PRODUCT: 200 Pie Display | | | | PART No: WPIP200-A001 | |
| NAME | SIGNATURE | DATE | UNLESS OTHERWISE SPECIFIED: DIMENSIONS ARE IN MILLIMETERS | DESCRIPTION: Assembly | |
| DRAWN N Wooler | | 20/12/2004 | | | |
| APPV/D | | | MATERIAL: 430 BA S/S | DWG No: WPIP200-D001 | |
| | | | THICKNESS: | REVISION | |
| | | | FINISH: Bright | A | |
| DO NOT SCALE DRAWING | | | This drawing remains the property of Tom Stoddart Pty Ltd & cannot be reproduced without prior permission. | | |
| | | | A3 | Sheet 6 of 41 | |